

Appendices 3

Trees specified by reference to an area

(within a dotted black line on the map)

<u>No. on Map</u>	<u>Description</u>	<u>NGR</u>	<u>Situation</u>
None			

Groups of Trees

(within a broken black line on the map)

<u>No. on Map</u>	<u>Description</u>	<u>NGR</u>	<u>Situation</u>
G1	1 x Ash 1 x Willow 1 x Sycamore 3 x Oak	408832-278512	Northern Boundary
G2	3 x Oak 1 x Lime	408784-278354	Western Boundary
G3	3 x Oak	408423-278267	Northern Boundary
G4	Group of mixed species native trees Ash, Oak, Hawthorn, Hazel and Malus	408630-277973	Liner feature on Southern Boundary running West to East.
G5	Group of mixed species native trees Oak and Hawthorn	409214-277942	Southern Boundary
G6	6 x Alder 2 x Oak	409421-277865	Eastern Boundary
G7	Group of mixed species native trees Oak, Ash and Alder	409421278094	Eastern Boundary along stream.

Appendices 3

G8	Group of mixed species native trees Oak, Alder, Willow, Pine and Hawthorn	409375-278243	Main body of site towards Northern boundary
G9	Group of mixed species native trees Oak, Alder, Ash and Silver Birch	409464-278338	Main body of site towards Northern boundary
G10	Liner group on boundary Peterbrook Road Oak, Holly, Sycamore, Silver Birch and Hawthorn.	409534-278381	Northern Boundary of the site

Woodlands

(within a continuous black line on the map)

<u>No. on Map</u>	<u>Description</u>	<u>NGR</u>	<u>Situation</u>
-------------------	--------------------	------------	------------------

None

Appendices 3

First Schedule

Trees specified individually

(encircled in black on the map)

<u>No. on Map</u>	<u>Description</u>	<u>NGR</u>	<u>Situation</u>
T1	Oak	408919-278449	Northern Boundary
T2	Oak	408783-278454	Western Boundary
T3	Oak	408857-278272	Main Body Of Site
T4	Ash	408816-278243	Main Body Of Site
T5	Ash	408843-278240	Main Body Of Site
T6	Oak	408930-278234	Main Body Of Site
T7	Ash	408973-278230	Main Body Of Site
T8	Oak	409028-278122	Main Body Of Site
T9	Oak	408740-278254	Northern Boundary
T10	Oak	408680-278250	Northern Boundary
T11	Oak	408666-278251	Northern Boundary
T12	Sycamore	408382-278104	Western Boundary
T13	Oak	409218-277921	Western Boundary
T14	Oak	409201-277904	Western Boundary
T15	Oak	4091880-277880	Close To Western Boundary
T16	Oak	409174-277877	Western Boundary
T17	Oak	409127-277838	Western Boundary
T18	Oak	409116-277829	Western Boundary
T19	Oak	409121-277799	South-Eastern Boundary
T20	Oak	409141-277804	South-Eastern Boundary
T21	Oak	409160-277811	South-Eastern Boundary
T22	Oak	409211-277828	South-Eastern Boundary
T23	Oak	409223-277841	Close To South-Eastern Boundary
T24	Beech	409270-278092	Main Body Of Site
T25	Oak	409284-278091	Main Body Of Site
T26	Oak	409391-278103	Main Body Of Site
T27	Oak	409407-278121	Main Body Of Site
T28	Pine	409091-278155	Main Body Of Site
T29	Oak	409087-278155	Main Body Of Site
T30	Oak	409080-278163	Main Body Of Site
T31	Beech	409112-278228	Main Body Of Site
T32	Sycamore	409264-278232	Main Body Of Site
T33	Silver Birch	409222-278246	Main Body Of Site
T34	Oak	409027-278082	Main Body Of Site
T35	Oak	409025-278205	Main Body Of Site
T36	Oak	408994-278293	Main Body Of Site
T37	Oak	408956-278302	Main Body Of Site
T38	Oak	408932-278302	Main Body Of Site
T39	Oak	408911-278311	Main Body Of Site
T40	Oak	409054-278264	Main Body Of Site
T41	Oak	409056-278281	Main Body Of Site
T42	Oak	409058-278306	Main Body Of Site

Appendices 3

Individual Trees - cont

T43	Ash	409059-278326	Main Body Of Site
T44	Oak	409058-278340	Main Body Of Site
T45	Oak	409043-278339	Main Body Of Site
T46	Oak	409043-278336	Main Body Of Site
T47	Oak	409049-278381	Boundary of access lane Northern side of site.
T48	Oak	409045-278394	Boundary of access lane Northern side of site.
T49	Ash	409056-278388	Boundary of access lane Northern side of site.
T50	Oak	409028-278440	Boundary of access lane Northern side of site.
T51	Oak	409025-278451	Boundary of access lane Northern side of site.
T52	Oak	409023-278459	Boundary of access lane Northern side of site.
T53	Oak	409018-278499	Boundary of access lane Northern side of site.
T54	Oak	409018-278509	Boundary of access lane Northern side of site.
T55	Sycamore	409033-278476	Boundary of access lane Northern side of site.
T56	Oak	408649-278252	Northern Boundary of site
T57	Oak	408624-278253	Northern Boundary of site
T58	Oak	408607-278254	Northern Boundary of site

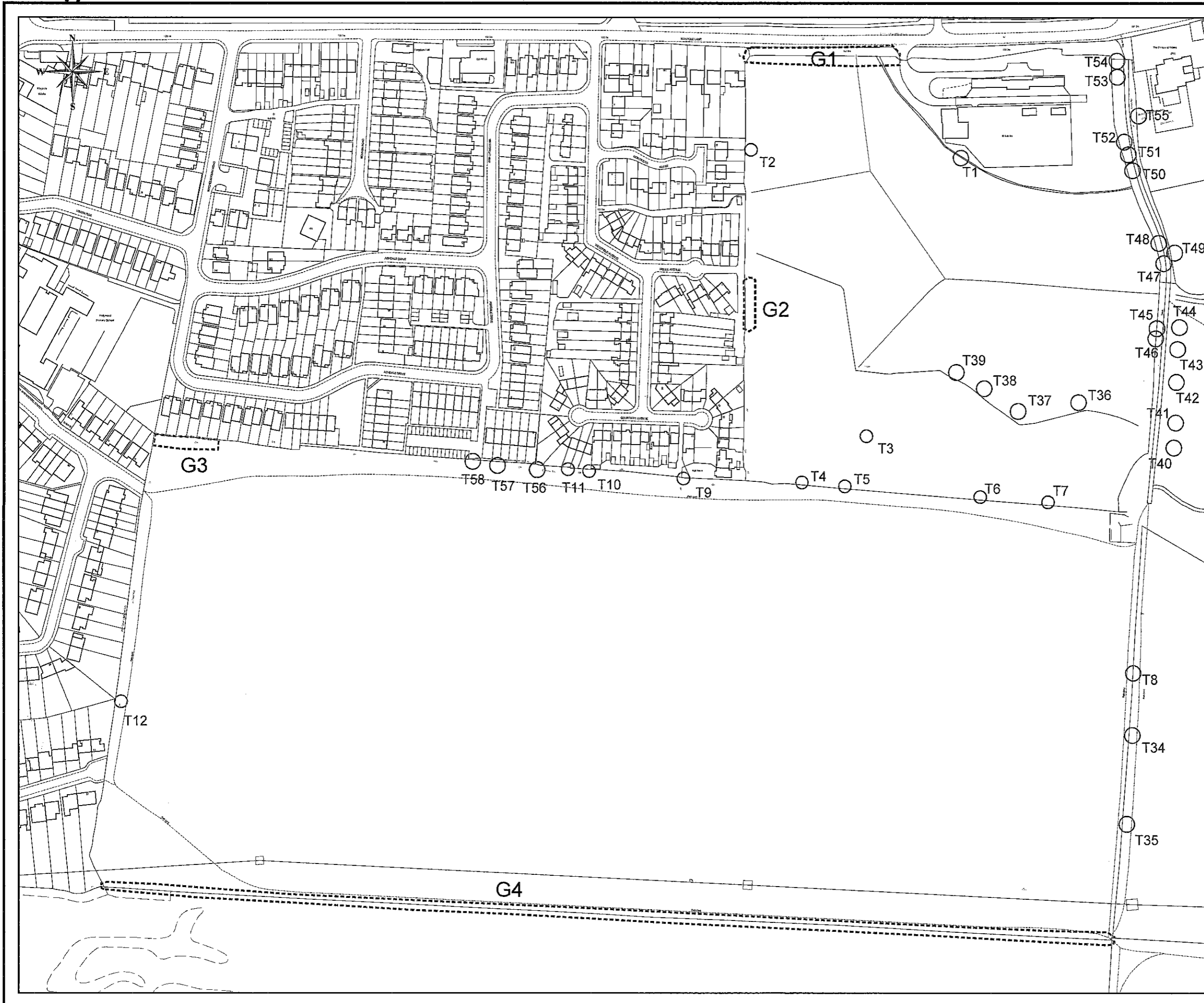

Notes:

Date	Rev	Details

Project:
**Bromsgrove District
 Tree Preservation Order
 (19) 2014
 PLAN (1)**

Drawing:
**Land Between
 Peterbrook Road, Maypole Lane
 and Gay Hill Golf Club
 Hollywood**

Drawn: AAA Scale: 1/2300
 Surveyed: AAA Date: 10 / 02 / 2015

Drawing No: **P0000/0**

Engineering and Design Services
 Town Hall
 Walter Stranz Square
 Redditch
 Worcs B98 8AH



Appendices 3

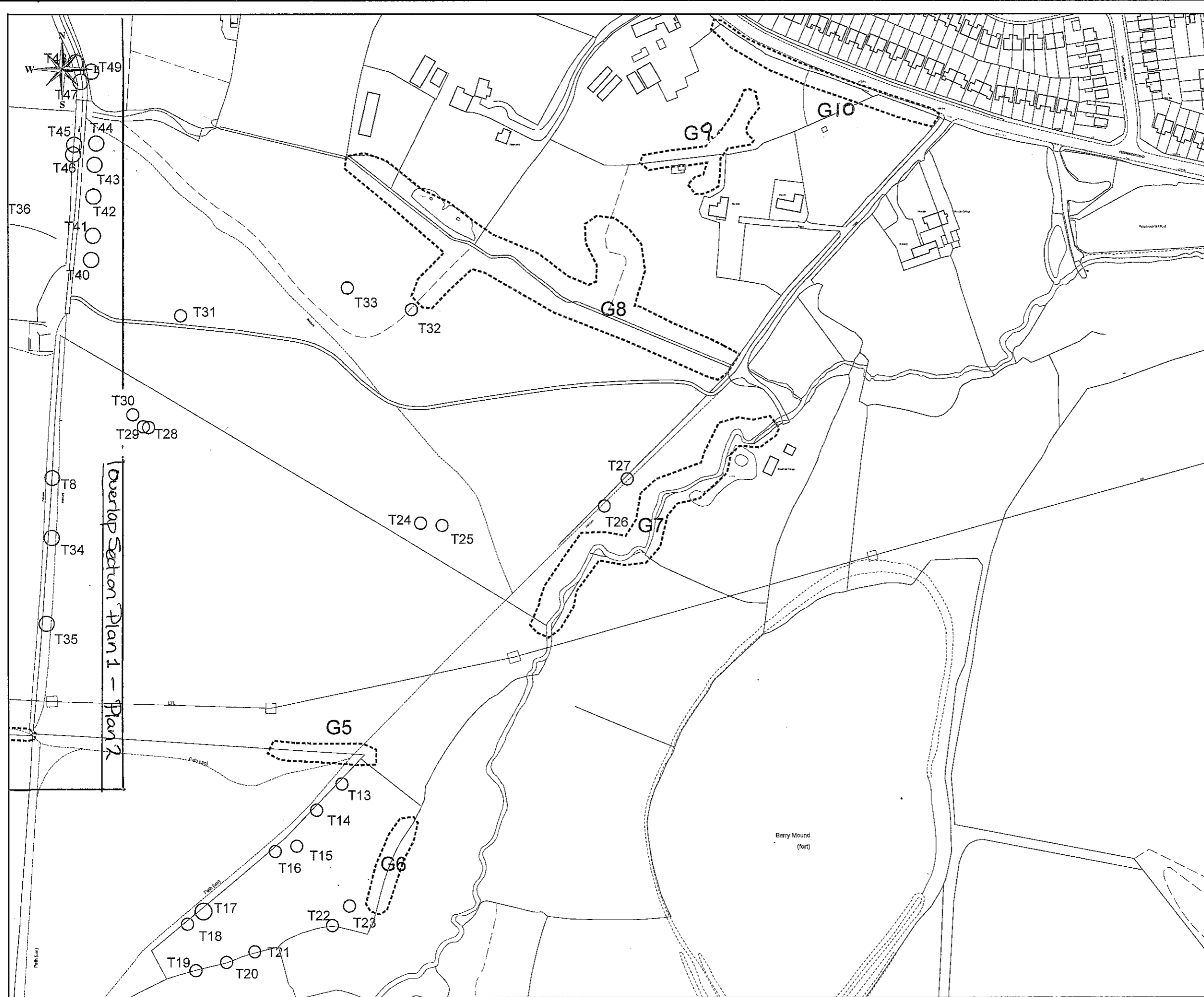

Notes:

Date	Rev	Details

Project:
**Bromsgrove District
 Tree Preservation Order
 (19) 2014
 Plan (2)**

Drawing:
**Land Between
 Peterbrook Road, Maypole Lane
 and Gay Hill Golf Course
 Hollywood**

Drawn: AAA Scale: 1/2400
 Surveyed: AAA Date: 10 / 02 / 2015

Drawing No: **P0000/0**

Engineering and Design Services
 Town Hall
 Walter Stranz Square
 Redditch
 Worcs B98 8AH

